

FOREST RIVER PRESENTS

WOLF PACK

LEAD THE PACK



WOLF PACK 1/2 ton models



27DF WP



Our DFWP models are half ton towables and have some of the industry's largest cargo areas period. As shown here even the complete walk around Queen bed flips up to allow for even more toys. Also, there are no wheel wells, even in our 102" LITE weight models. ANOTHER Industry first, no other Lite weight toy hauler can claim that. The storage is maximized in every single floorplan, as shown here.



All Wolf Packs feature a Black Tank Flush that helps keep your black tank clean. This will allow you to spend more time doing all the things you enjoy, instead of where the other guys will be spending that precious time cleaning out their septic systems.



BLACK TANK FLUSH



BATTERY DISCONNECT

We understand that Wolf Pack owners use their units a lot more than other users. Instead of hooking and unhooking dirty grimy battery wires just flip the convenient battery disconnect in your Wolf Pack.



27DFWP



18DFWP

The 18DFWP is a Widebody, and you can easily see the extra room in this spacious model. This unit has the 12 volt AM/FM/CD/DVD system that's really impressive to hear. The dinette booth is large enough for 4 adults to sit around and eat comfortably.





396WP



The 396 WP is the Ultimate Toy Hauler. Loaded with tons of Industry Firsts, this toy hauler puts all others to shame. Watch the Large 35" LCD TV from the comfortable West Sofa, that also holds a comfortable Queen size air mattress. Yes, that is TWO large side-by-side refrigerators right next to your convection microwave. Loaded has a new meaning, because this unit is LOADED!!!



396WP

Wolf Pack owners know that a hard day's work can get a little grimy. That is why Wolf Packs feature large and spacious showers that all have a standard skylight in the shower for extra head room.

The optional Rhino Kit is our Industry Exclusive Dinette that is now available for those with taller toys.



295WP

Wolf Pack features the Industry's First Electric Dinette, with enough clearance to get in even the biggest of toys. You can comfortably sit 6 adults at this HUGE table. When your done eating and playing, this dinette breaks down into a California Queen Bed. You can also option in a second queen bed above the dinette if you wish. Optional queen bed and optional Rhino Kit shown here.



WOLF PACK FLOORPLANS

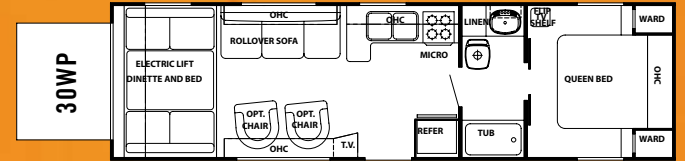
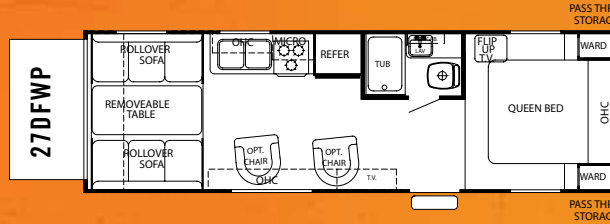
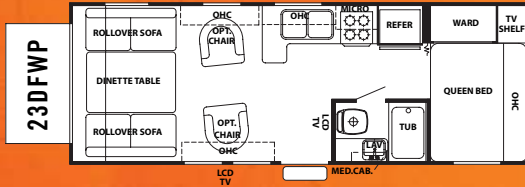
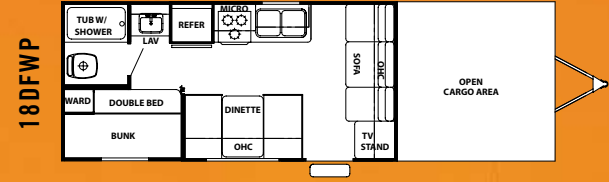
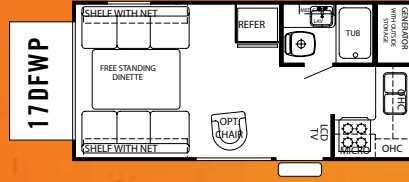
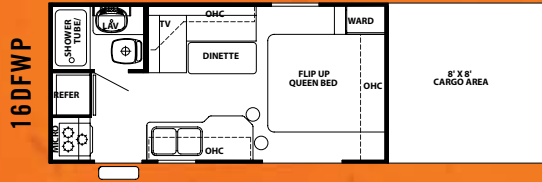

TRAVEL TRAILERS

FIFTH WHEELS

	T16-DFWP	T17-DFWP	T18-DFWP	T23-DFWP	T27-DFWP	30-WP	F285-WP	F295-WP	F326-WP	F326+5-WP	F386-WP	F396-WP
Hitch Weight	TBD	847	508	1064	1011	1340	1891	1297	2448	2283	2587	2924
Axle Weight	TBD	4030	4762	4859	4888	6420	6984	6853	8148	8984	10261	10713
UVW	TBD	4877	5270	5923	5899	7039	8875	8150	10596	11267	12848	13637
Payload	TBD	2970	2238	2141	2112	4701	3416	3547	7452	6616	5339	4887
Unit Height w/AC	10'-9"	11'-7"	10'-9"	11'-7"	11'-7"	12'-5"	12'-6"	12'-6"	12'-6"	12'-6"	13'-4"	13'-4"
Fresh Capacity	50-gal.	110-gal.	50-gal.	110-gal.	110-gal.	110-gal.	110-gal.	110-gal.	110-gal.	110-gal.	110-gal.	110-gal.
Fuel Capacity	30-gal.*	30-gal.*	30-gal.*	30-gal.*	30-gal.*	30-gal.*	30-gal.*	30-gal.*	30-gal.*	30-gal.*	30-gal.	30-gal.
Awning	15'	15'	15'	18'	18'	18'	18'	18'	18'	21'	21' **	21' **
Interior D/S	TBD	165"	N/A	160"	269"	214"	64"	214"	225"	284"	142"	142"
Interior O/D/S	TBD	102"	N/A	125"	77"	180"	64"	180"	192"	249"	142"	142"

* Optional ** = Electric Powered



WOLF PACK FLOORPLANS

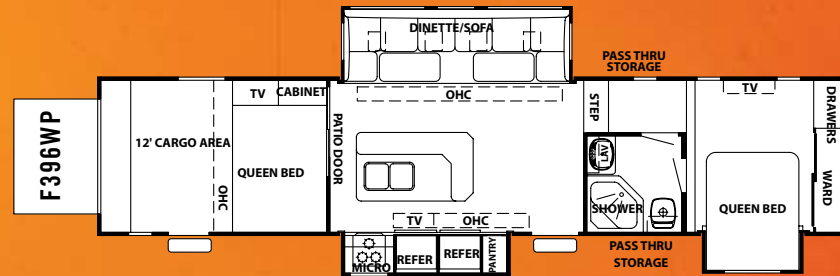
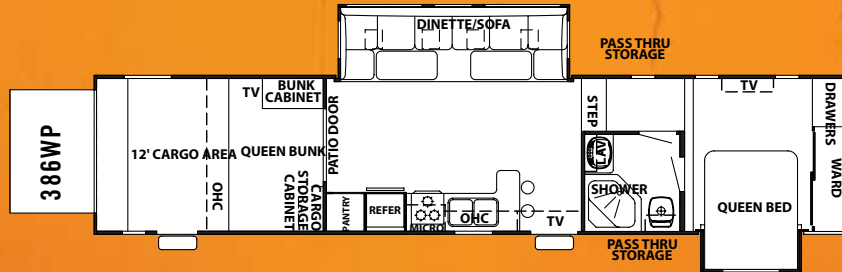
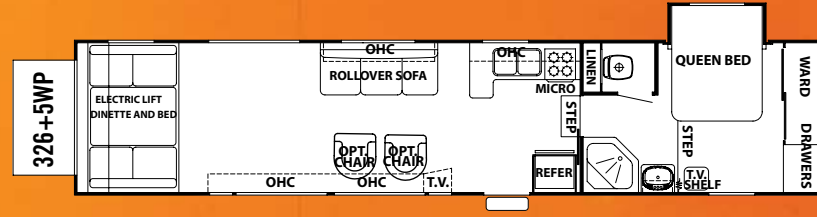
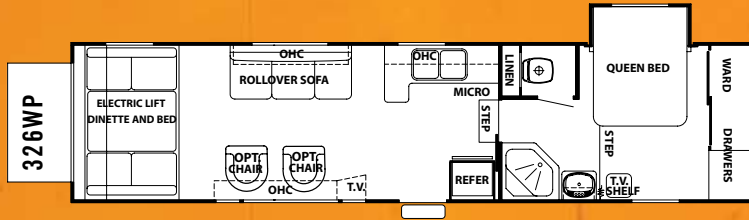
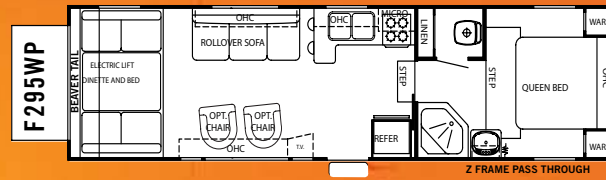
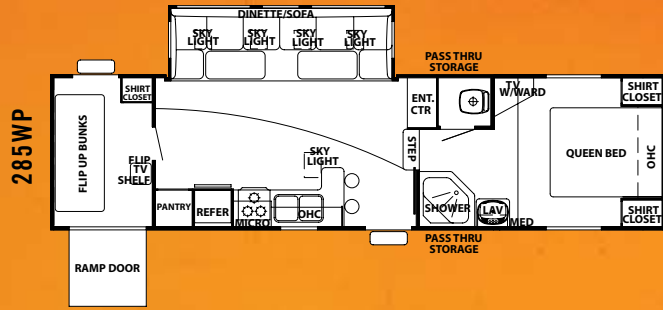

WOLF PACK fabrics

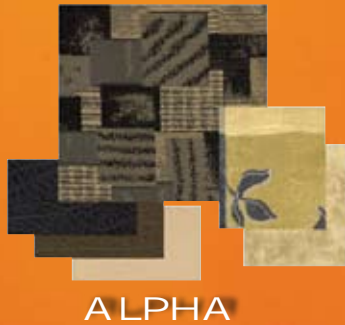

WOLF PACK



WOLF PACK SPECIFICATIONS

STANDARD FEATURES

- Industry Exclusive Electric Dinette with Optional Second Queen Power Bed
- 102" Widebody
- No Wheel Wells
- Full-Caged Ramp Door
- Battery Recharging Solar Panel
- 4 X 4 Wolf Pack Beaver Tail
- 2,500 Lbs Flush Floor Mounts
- Exterior Speakers
- Sprayer Hose (Opt. on DFWP)
- Battery Disconnect
- Fuel Timer with Emergency Cut-off
- Breakfast Bar (in select floorplans)
- 12 volt Utility Plug
- Bunk Window Cargo Net
- Diamond Plate Back Splash
- 13.5 BTU High Efficiency A/C
- Racing Checkered Awning
- Cable And Satellite Ready
- 20" Television
- DVD Player
- Safety Glass
- Onan Generator Prep
- Over 110 Gallon Fresh Water
- Black Tank Flush
- 3 Burner Range
- Extra Large Ramp Door
- High Rise Kitchen Faucet
- Raised Panel Doors
- Double Shelved Cabinets
- Exterior Ladder To Roof (opt. on DFWP)
- Diamond Plate
- Extra Large Lipert Axles
- Stabilizer Jacks
- Turbo 6 Gallon Gas/Electric DSI Water Heater
- 3/8" Walkable Roof Decking
- Radius Truss Roof Rafters
- 5/8" Tongue and Groove Plywood Floor
- Powder Coated Frame
- Aluminum Rims
- Granite Look Laminated Countertops
- Bar Stools (in select floorplans)
- Extra Large Tinted Windows
- Exterior Sewer Hose Holder
- TV Antenna & Booster
- 30" Radius Entry Door
- Sealed Floor
- Water Heater Bypass
- Triple Step
- Flex Blinds
- Rain Gutters & Down Spouts
- Pillowtop Mattress (in select floorplans)
- LP Leak Detector
- Tub Surround (opt. on DFWP)
- Upgraded Cabinet Handles
- Clear Fantastic Fan Dome
- Two Coat Hooks
- Decorative Clock
- Dual 30# LP Bottles (opt. on DFWP)
- Residential Grade Cabinets

AVAILABLE OPTIONS

- Front Cap Gel Coat With Aluminum Exterior
- Gel Coat Cap And Side Walls
- Large Exterior Folding Assist Grab Handle
- Ramp Patio Room
- Ceiling Fan 12 Volt
- Wolf Pack Chair
- Plank Wood Linoleum
- Telephone Jack Location: Kitchen
- Raised 6 Panel Refer Insert
- Solid Surface Edged Countertops
- Day/Night Shades
- LCD Flatscreen TV
- Sink Cover
- Range Cover
- Oven
- 10 Gallon Gas/Electric DSI Water Heater
- Heated Holding Tanks
- Power Awning
- 15k Air Conditioner
- Screen Wall
- 2nd Queen Power Bed
- Onan Brand Generators
- Rhino Kit
- Box Crush Premium Sound System

SOUTHWEST PACKAGE

- Spare Tire and Carrier
- Scare Light (Rear)
- Gas Pump Fuel Station w/ Generator Direct
- Sky Light Over Tub
- Removable Rear Room Edged Carpet

CONVENIENCE PACKAGE

- 10,000 Gallon Water Filter System
- Bathroom Fantastic Vent Fan w/ Clear Dome
- Remote Control Cd/Cassette Stereo System
- 6 + 2 Surround Sound Stereo Speaker System
- Carbon Monoxide Detector



402 LEHMAN AVE., TOPEKA, IN 46571,
SALES PHONE: 260.593.2539, SERVICE PHONE: 260.593.2428 FAX: 260.593.2966
WWW.FORESTRIVERINC.COM, WWW.FORESTRIVERACCESSORIES.COM

All illustrations and specifications contained in this literature are based on the latest product information at time of publication. Forest River reserves the right to make changes in prices, colors, materials, equipment and specifications at anytime without notice and assumes no responsibility for any error in this literature. All units are shipped F.O.B. Goshen, Indiana. **CONSULT YOUR LOCAL DEALER FOR WARRANTY INFORMATION.**

FOR 0580 LITHO: U.S.A.

YOUR **WOLF PACK** DEALER